

SAM LINDSAY AQUATIC CENTRE – SCHEDULE C

• **Pool Rental Rates**

Time (rates are per hour)	Youth		Adult	
	A	B	A	B
Rental Rates				
All normal operating hours.	92.90	49.20	125.65	66.70
Adhoc Pool Rentals²	A, B, & C		A, B, & C	
Outside normal operating hours Youth = 75% of adult rate	163.95		218.55	

1. Youth volume purchased pool time minimum 1 hour/day, Monday to Friday, 40 weeks/year.
2. Maximum 75 people. Intent of program rate is to capture all costs of on-deck personnel and meet policy relative to ratios between guards and participants. If there are additional participants, the cost would be the hourly labour cost including benefits plus 25%.
3. Persons or groups wishing to rent the complete facility will be required to pay all costs of additional on deck personnel and meet policy relative to ratio between guards and participants. Cost is \$41.15 for each 25 participants above 75 people.

The Sam Lindsay pool is available to rent as a whole unit or in subsections:

- A. 25 meter length swim area plus shared use of sauna and whirlpool
- B. 10 meter shallow end swim area plus shared use of sauna and whirlpool
- C. Leisure Pool plus shared use of sauna and whirlpool; waterslide is optional; intent is to capture all costs of waterslide personnel; cost = hourly labour rate + benefits for a slide attendant
- D. Lane rentals. Individual lane rentals are available at the rate of \$14.85 per hour provided that:
 - a. The lane area is not booked for other purposes
 - b. The pool is open and qualified people are on duty

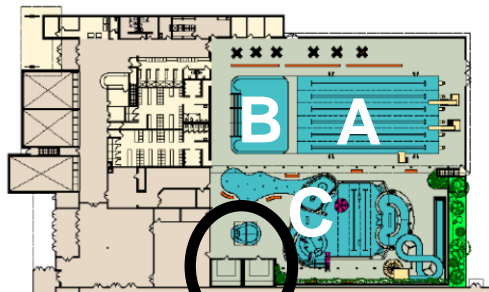

Shared use area

• **Sauna and Whirlpool**

1. This area is a common area for use by all participants using the various pools, provided that:
 - a. The complete pool is not separately booked (i.e. private rental);
 - b. The pool is open and qualified people are on duty.
2. Use of the sauna and whirlpool area is included when playing racquet sports or using the fitness centre, provided that:
 - a. The complete pool is not separately booked (i.e. private rental);
 - b. The pool is open and qualified people are on duty.
3. Use of these facilities is restricted to participants 16 years of age and over, unless accompanied by an adult.

• **Pool Rental Rates for Non-Residents**

Adult	Adult Ad Hoc pool rental rate + 25% surcharge
Youth	Youth Ad Hoc pool rental rate + 25% surcharge